

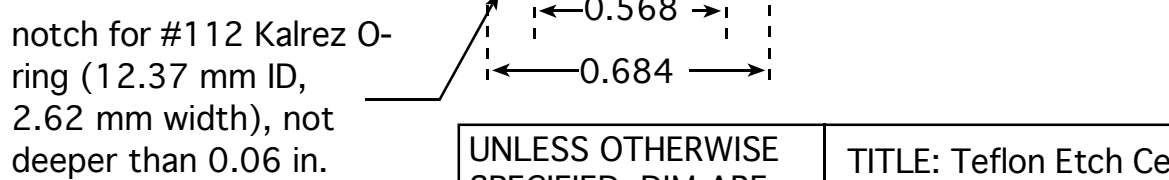

UNLESS OTHERWISE SPECIFIED, DIM ARE INCHES, MATERIAL IS TEFLON	TITLE: Teflon Etch Cell
	Designer: M. J. Sailor
University of California San Diego	University of California, San Diego Dept. of Chemistry and Biochemistry Sailor Research Group Pacific Hall room 4140 PH: 858 534 8945

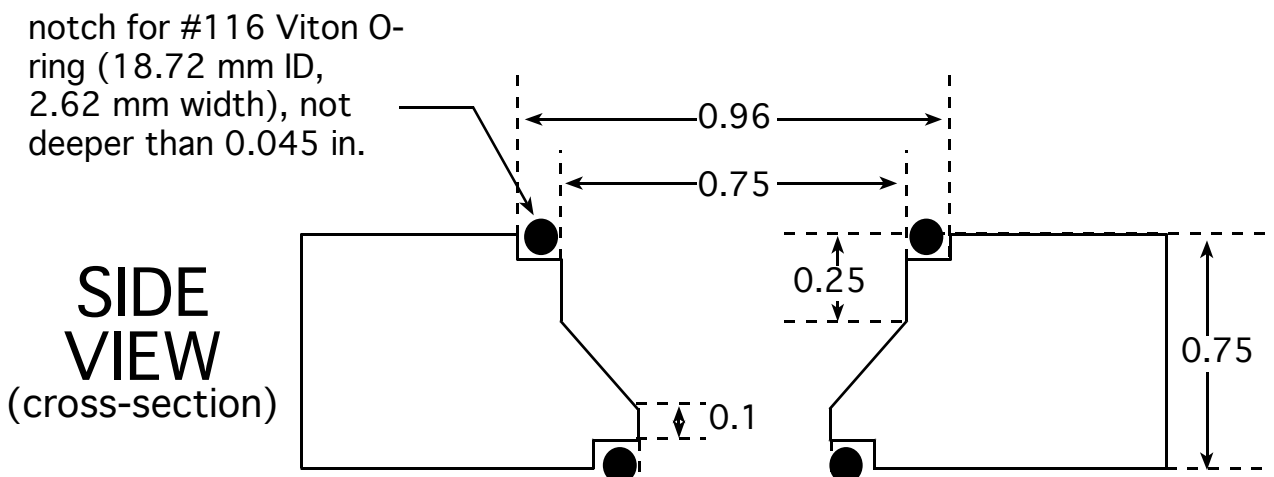

UNLESS OTHERWISE SPECIFIED, DIM ARE INCHES, MATERIAL IS TEFLON	TITLE: Teflon Etch Cell Top
	Designer: M. J. Sailor
University of California  San Diego	University of California, San Diego Dept. of Chemistry and Biochemistry Sailor Research Group Pacific Hall room 4140 PH: 858 534 8945

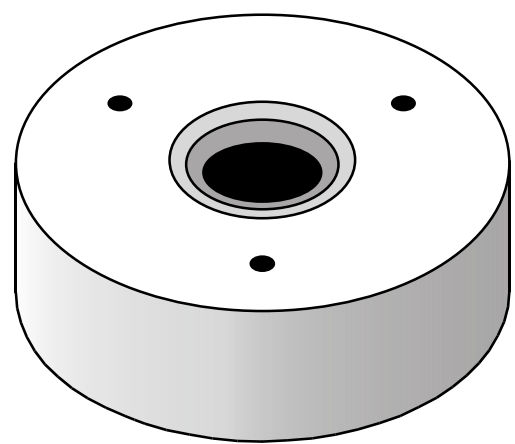
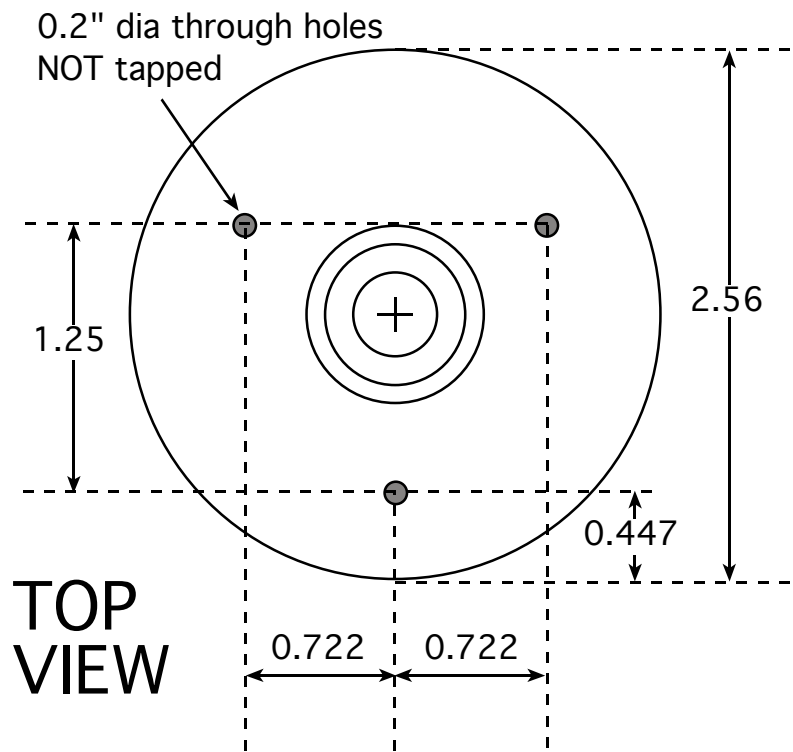

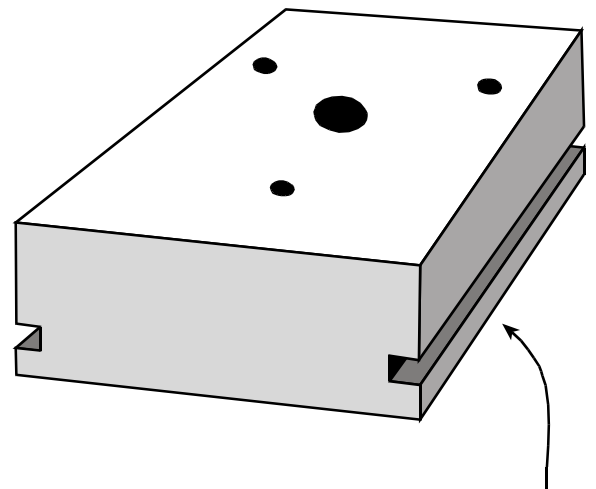
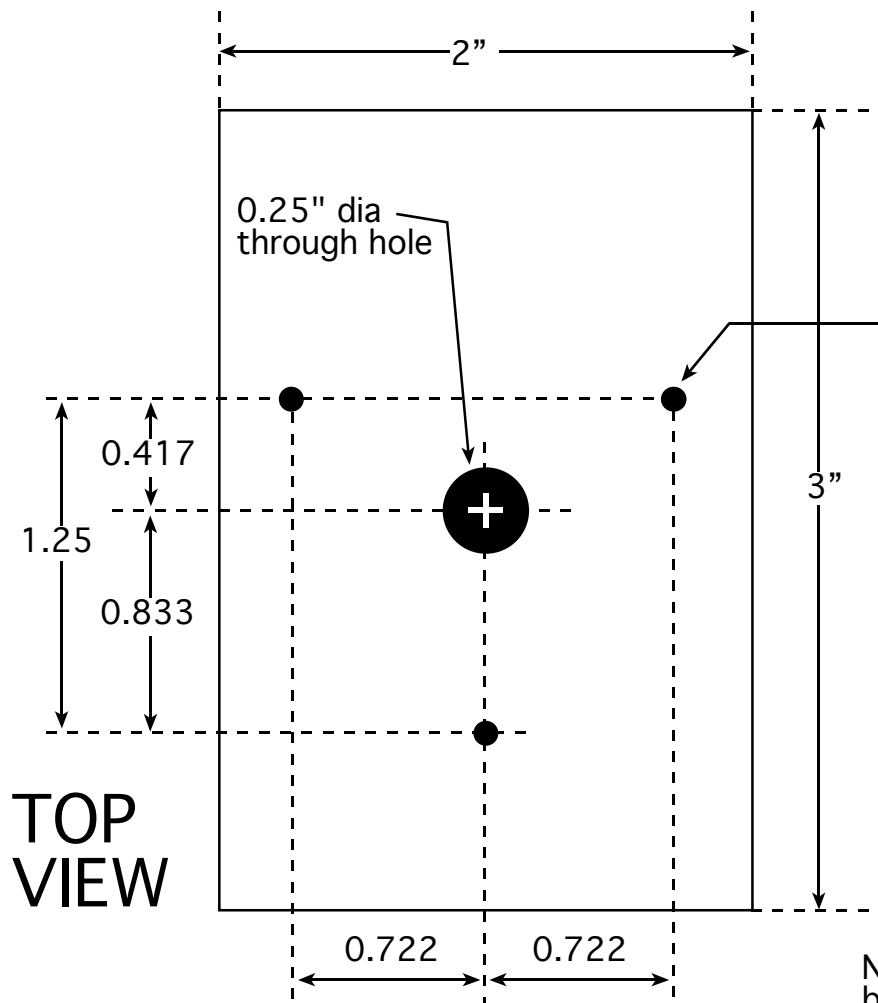
Note: these grooves allow the fixture to be mounted in a conventional FTIR instrument. If the electrode contact (Al foil typically) has a hole that coincides with the central 0.25" dia hole in the Teflon piece, a transmission-mode infrared spectrum of the porous Si film can be obtained without de-mounting the chip

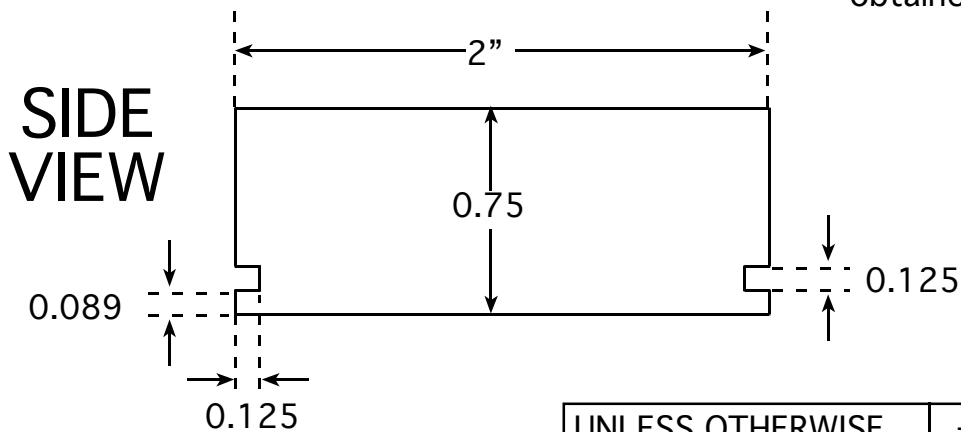

UNLESS OTHERWISE SPECIFIED, DIM ARE INCHES, MATERIAL IS TEFLON

TITLE: Teflon Etch Cell Base

Designer: M. J. Sailor

University of California
San Diego

University of California, San Diego
 Dept. of Chemistry and Biochemistry
 Sailor Research Group
 Pacific Hall room 4140
 PH: 858 534 8945